

Optimator Top Entry

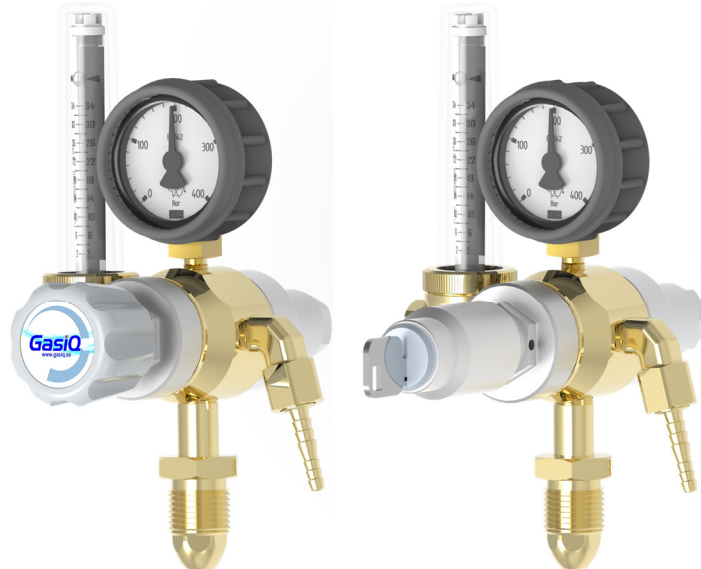

Product features

The Optimator from GasIQ offers enhanced efficiency, quality, and sustainability for welding applications, with a quick return on investment and environmental consideration.

- **Two-stage system:** The Optimator from GasIQ is the original two-stage system, ensuring precise control of gas flow for welding applications.
- **Efficient gas savings:** The Optimator's second stage effectively reduces the gas surge during the initial welding moment, resulting in gas savings up to 54%.
- **Improved welding quality:** Reduced gas surges lead to improved weld quality by minimizing porosity in welds.
- **Enhanced welding quality:** Optimized to increase welding quality to meet high performance requirements.
- **Quick return on investment:** Estimated ROI in 6 months, making investment economically advantageous.
- **Environmentally friendly:** Environmentally friendly by reducing gas transportation, contributing to sustainable development.
- **Lockable option:** Also available as a lockable option with a robust lock for extra security and protection.

Technical data

Type	2-stage / cylinder
Regulator class	0
Standard	ISO 2503
First step calibrated at	5 bar
Gas	Ar/mix / Ar/H ₂
Temperature range	20°C up to +60°C

Pressure / Flow

Inlet pressure P ₁	200 bar
Outlet pressure	Depending on flow 0,2-1 bar
Q _n	0-34L/min

Materials:

Valve body	CW 614N
Valve seat	Kel-F
Diaphragm	NBR
Valve cap	Aluminum, EN 6026
Hand wheel	ZINK, ZP0410
Flow tube	Grilamid TR90°

Connections:

Inlet	See page 2
Outlet	See page 2

Dimensions

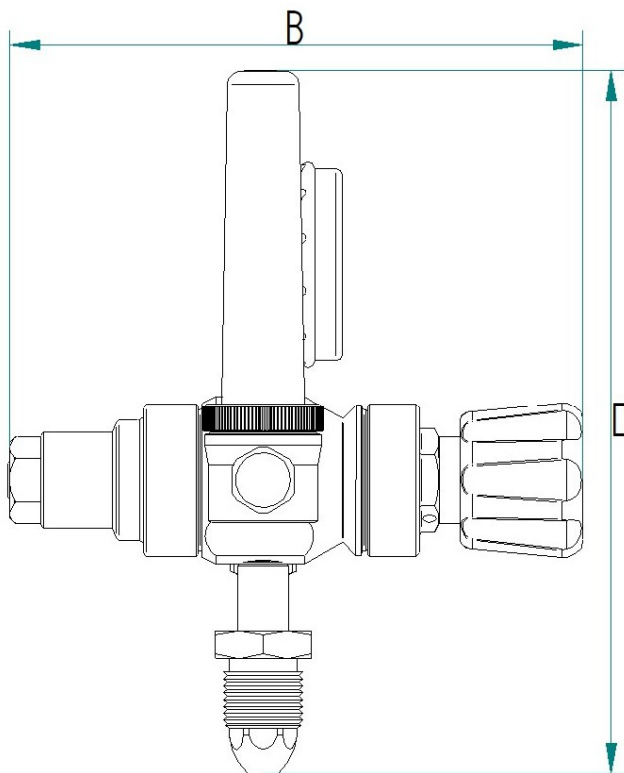
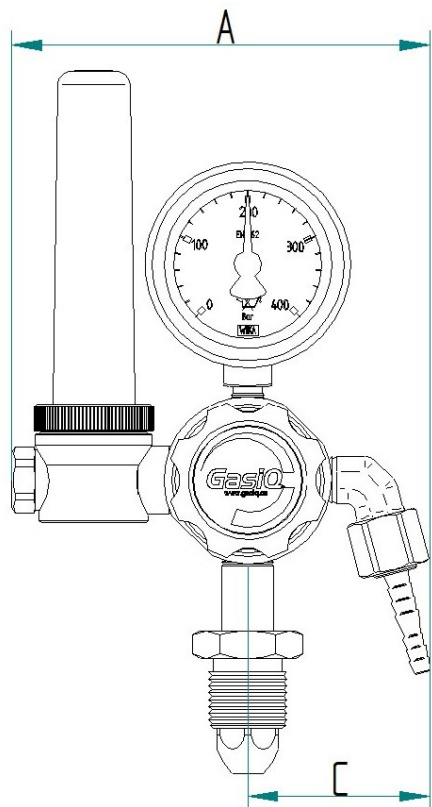

Handwheel					
Inlet	Outlet	A	B	C	D
G5/8" Bull M	G3/8"	123mm	168mm	54mm	205mm

Lockable					
Inlet	Outlet	A	B	C	D
G5/8" Bull M	G3/8"	123mm	189mm	54mm	205mm
G5/8" Bull L M	G3/8"	123mm	189mm	54mm	205mm